



2600 WINTER ST NE MINNEAPOLIS, MN 55413

FOR LEASE

[Website Link](#)



FOR MORE
INFORMATION
PLEASE CONTACT

Thomas A. Lelich
First Vice President
952.924.4675
tom.lelich@cbre.com

Kathy Frandrup
Client Services Team Lead
952.924.4619
kathy.frandrup@cbre.com



2600 WINTER ST NE MINNEAPOLIS, MN 55413

FOR LEASE

[Website Link](#)

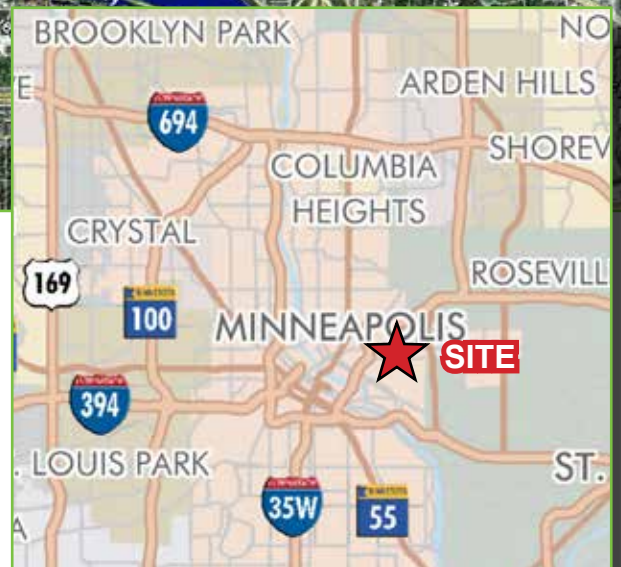
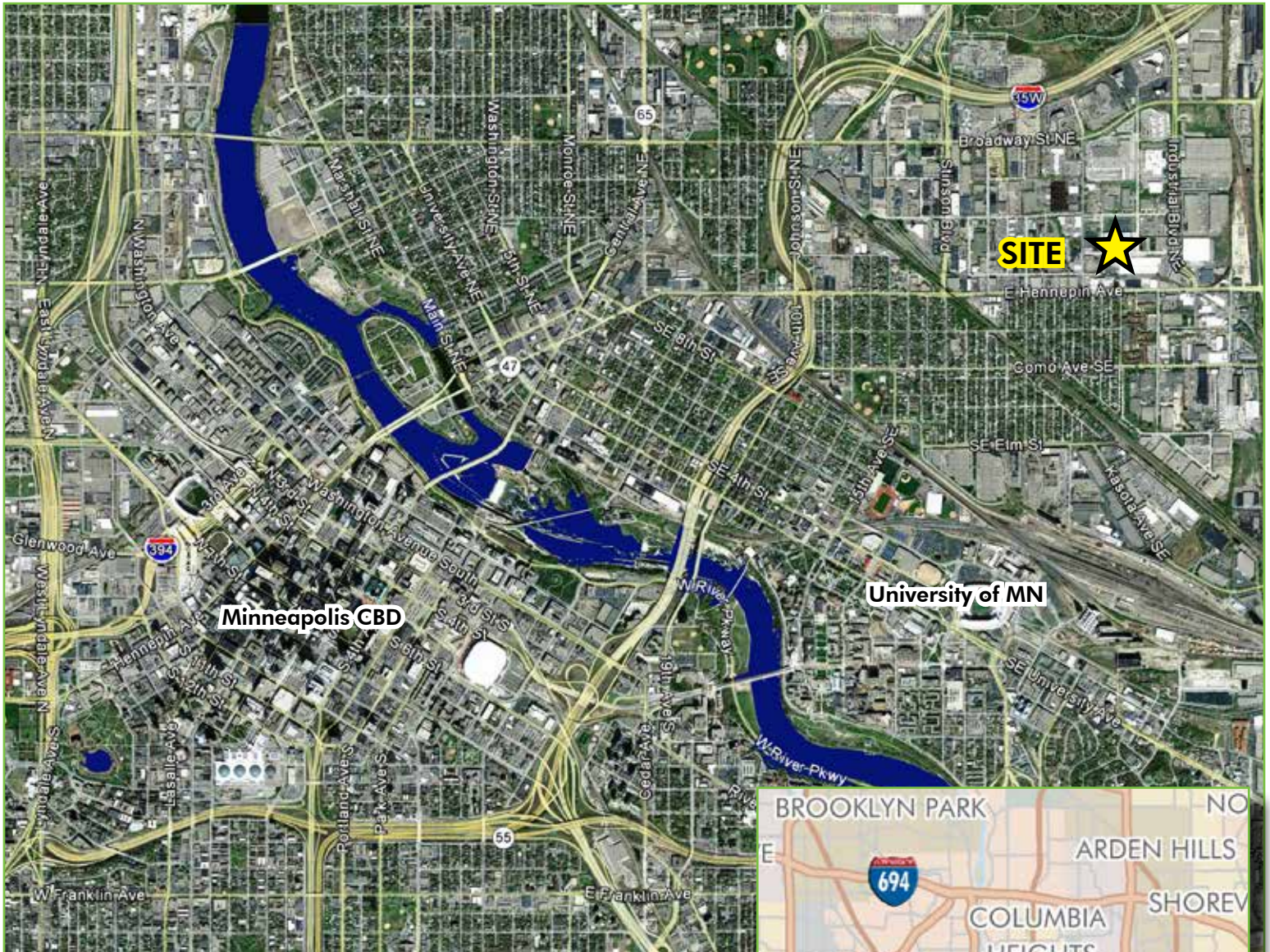

2013 Est. Demographics	1 Mile	3 Miles	5 Miles	10 Miles
Population	8,567	135,991	447,043	1,220,172
Growth 2013-2018	3.65%	5.26%	3.96%	3.80%
Avg Household Income	\$52,114	\$58,550	\$57,951	\$67,225

©2013 CBRE, Inc. The information above has been obtained from sources believed reliable. While we do not doubt its accuracy, we have not verified it and make no guarantee, warranty or representation about it. It is your responsibility to independently confirm its accuracy and completeness.

FOR MORE
INFORMATION
PLEASE CONTACT

Thomas A. Lelich
First Vice President
952.924.4675
tom.lelich@cbre.com

Kathy Frandrup
Client Services Team Lead
952.924.4619
kathy.frandrup@cbre.com

CBRE

2600 WINTER ST NE MINNEAPOLIS, MN 55413

FOR LEASE

[Website Link](#)



Address:	2600 Winter Street Northeast
Available SF:	±162,000 (divisible)
Office SF:	±12,000 (divisible)
Warehouse SF:	±150,000
Lot Area:	±17.1 acres
Clear Height:	26'
Loading:	15 docks, 1 drive-in (20' x 14')
Construction:	Tilt-up concrete
Year built:	1972
Sprinklered:	Yes, wet system
Power:	480/2787 Volts / 2000 Amps / 3-Phase
Column Spacing:	40' x 50'
Parking:	±200 vehicles
Rail:	MN Commercial; 3 rail doors (14' x 10')
PID #:	18-209-23-43-0041
Lease Rates:	Negotiable
2013 Taxes:	\$0.58/SF
Comments	<ul style="list-style-type: none"> Conveniently located 'high bulk' distribution space Quick access to I-35W and I-94 freeways, and Hwy 280 via Hennepin Ave

FOR MORE
INFORMATION
PLEASE CONTACT

Thomas A. Lelich
First Vice President
952.924.4675
tom.lelich@cbre.com

Kathy Frandrup
Client Services Team Lead
952.924.4619
kathy.frandrup@cbre.com

CBRE

2600 WINTER ST NE MINNEAPOLIS, MN 55413

FOR LEASE

[Website Link](#)

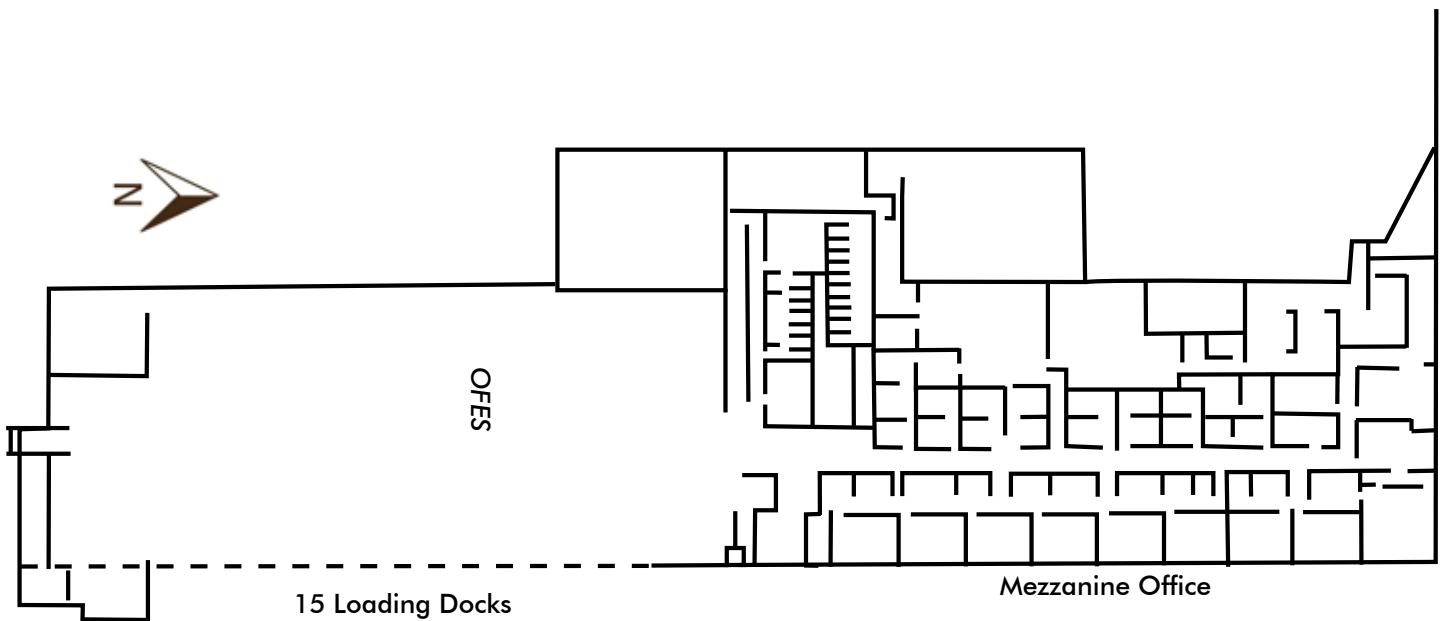
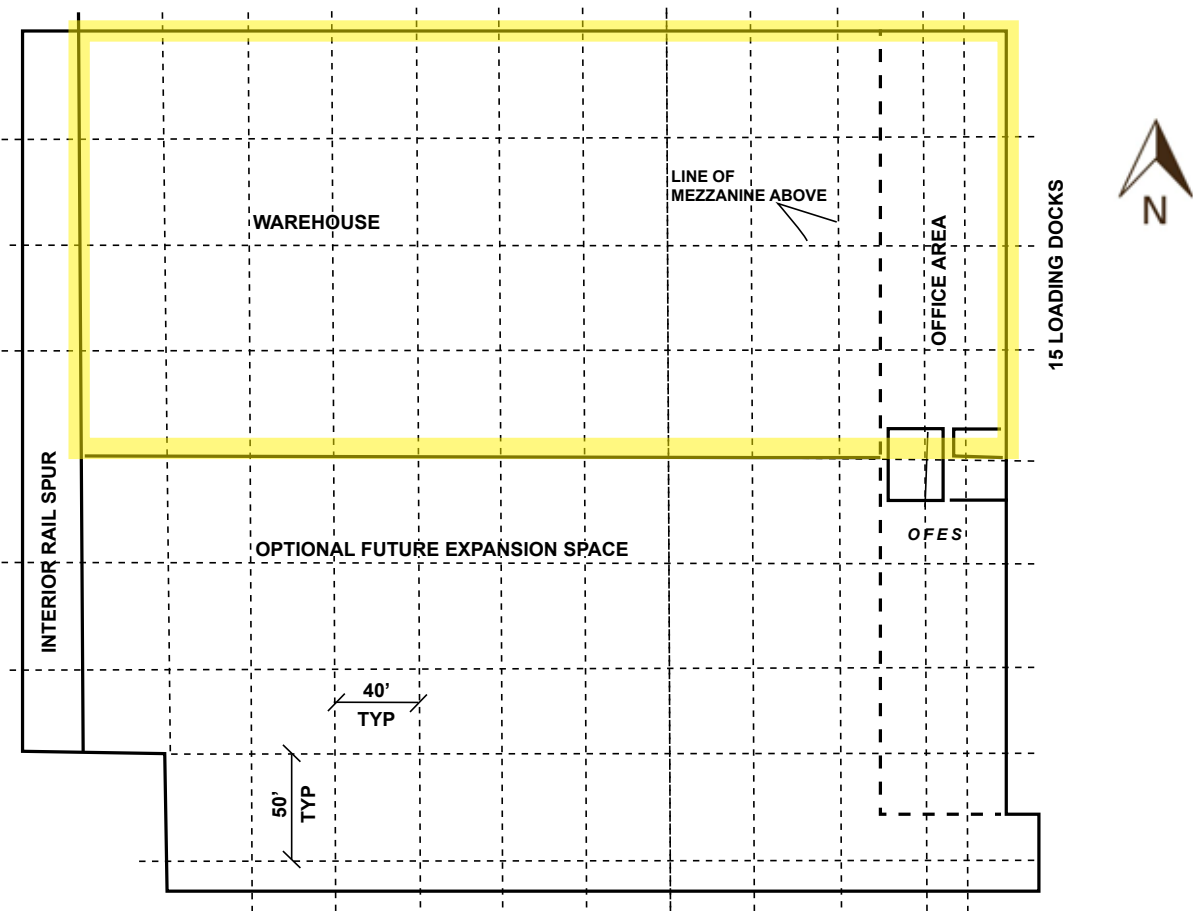

**FOR MORE
INFORMATION
PLEASE CONTACT**

Thomas A. Lelich
First Vice President
952.924.4675
tom.lelich@cbre.com

Kathy Frandrup
Client Services Team Lead
952.924.4619
kathy.frandrup@cbre.com

